

CITY OF MURRAY CONTROL MONUMENT CARD

DESIGNATION: BM D8
TYPE: CONCRETE MONUMENT W/ CITY DISK
DATE SET: JUNE 1997 QUAD: MURRAY, KY.
HORIZONTAL DATUM: NAD-83 VERTICAL DATUM: NAVD-88
STATE: KENTUCKY COUNTY: CALLOWAY ZONE: KY. S 1602

NORTHING: 1744811.54 FT
EASTING: 891216.41 FT
ELEVATION: 497.24 FT (GPS)
LATITUDE: N 36°35'32.16239" LONGITUDE: W 088°18'07.72346"
SCALE: CONVERGENCE:
PLANE AZI. TO AZI. MARK:

To Reach: From the intersection of River Rd. and S. 4th St. go southeast on S. 4th St. for 200 ft. to the station on the left.

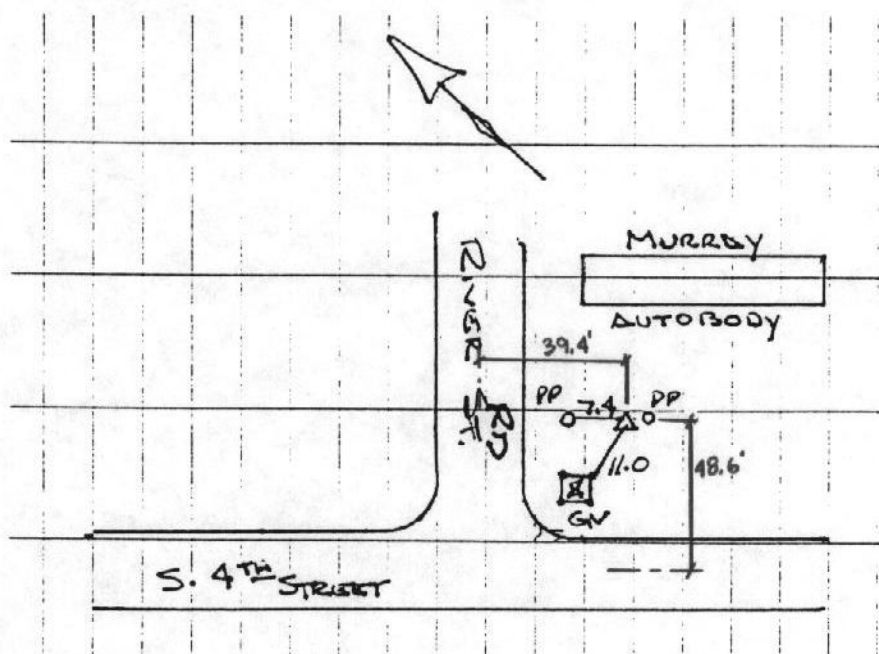

NOT TO SCALE



GRW Aerial Surveys, Inc.
801 Corporate Dr. Lexington Ky. 40503
(606)223-3999